

**DLR
M-Oberpfaffenhofen**

Wettbewerb 2004 - 1.Preis
Fertigstellung 2009

Baukosten 14,5 Mio. Euro
BGF: 7.800 m²

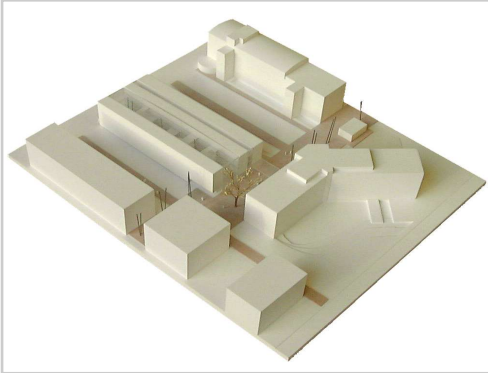

Modell

Tragwerksplanung:
Kunkel+Partner,
Düsseldorf

Energiekonzept:
Transsolar,
Stuttgart

Freianlagen
FSW-Landschaftsarchitekten,
Düsseldorf

TGA
RS-Ingenieure
München

Stich und Wieser Ingenieure



Lageplan

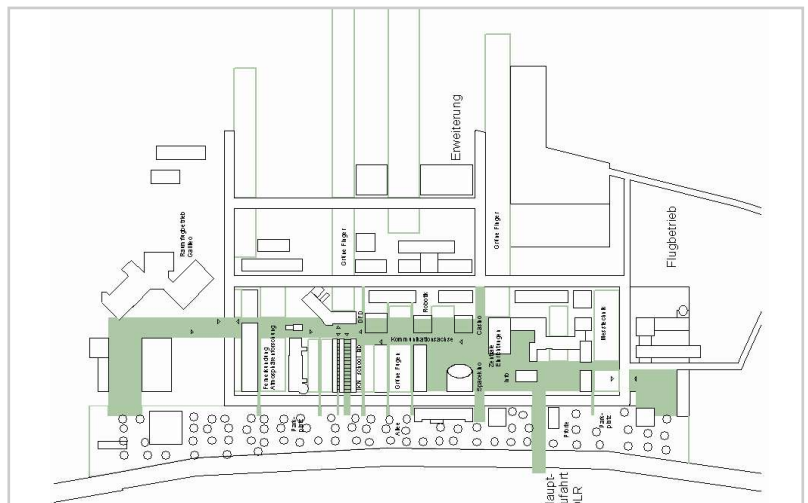

**DLR
M-Oberpfaffenhofen**

Wettbewerb 2004 - 1.Preis
Fertigstellung 2009

Baukosten 14,5 Mio. Euro
BGF: 7.800 m²

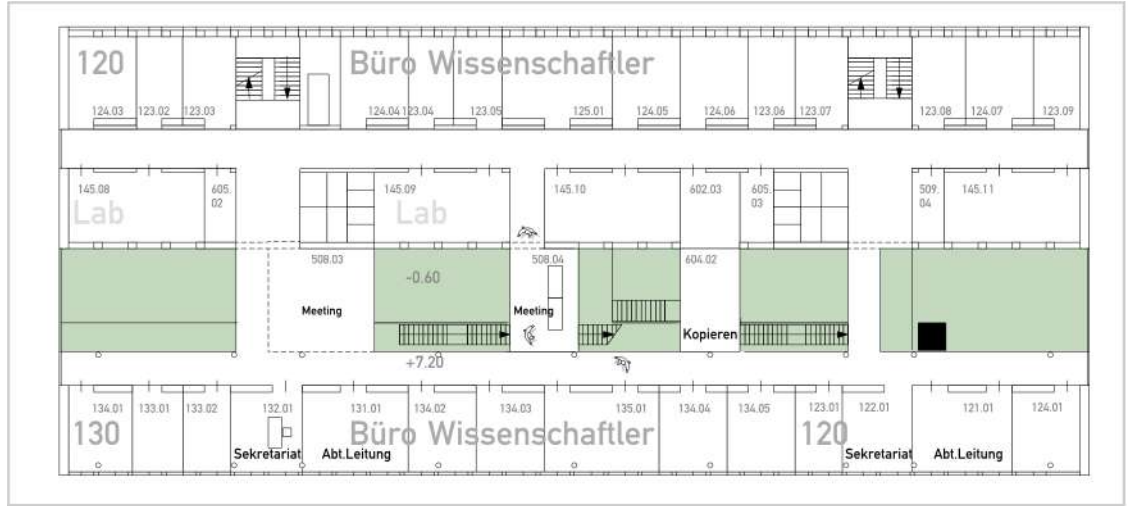

^^ Grundriss 2.0G



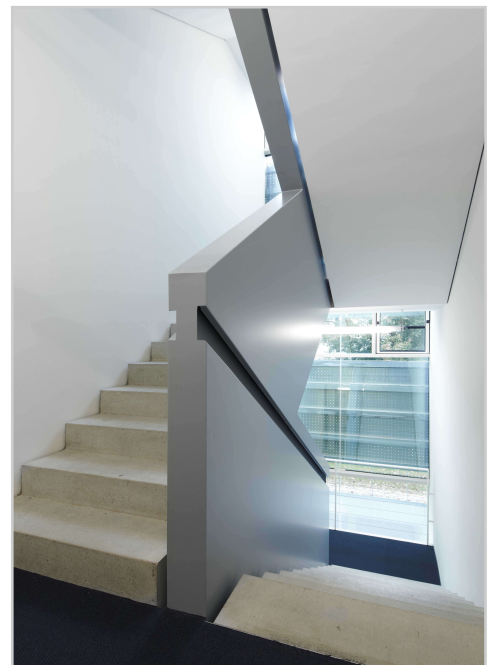
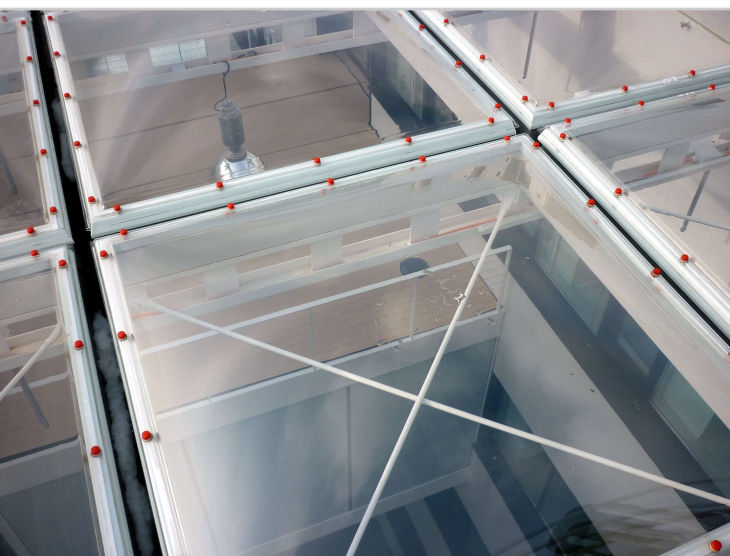
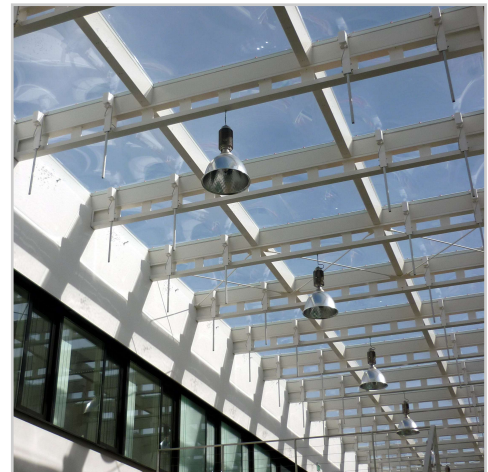
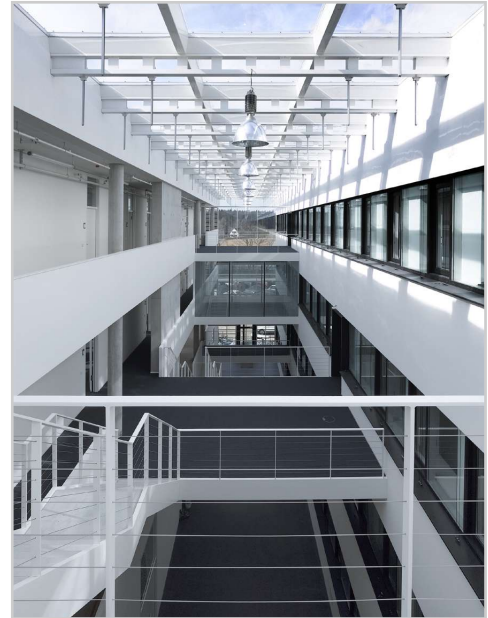

Atrium, Lichtkuppeln ^^
Treppenhaus >>